

EVERETT S&DC

Area: WestPac
District: Washington
Site: Everett Hub
ZIP Code: 98203

ROUTE INFO

Current City Routes 47
Current Rural Routes 10
Total Current Routes 47

Future City Routes 150
Future Rural Routes 12
Total Future Routes 162

MACHINE INFO

Sort Plan 1 Sort Plan
Current SDUS 64 Bins
Proposed SDUS 200 Bins

SPOKE SUMMARY

Spokes

- Bothell-Mill Creek PO
- 98012 - 30 City, 2 Rural
- 98021 - 17 City, 0 Rural
- North City CAX
- 98125 - 30 City, 0 Rural
- 98155 - 26 City, 0 Rural

Total Fit Spoke Routes 105

OTHER NOTES

1. Addition of the SDUS+ had shifted the reject bin closer to the bottom aisle. Aisle was reduced from 8' down to 6' to allow for space
2. LOG closest to the end of the machine may need to be notched

APPROVAL - Description	DATE
EXECUTIVE DIRECTOR, INSIGHTS AND OPERATIONAL EXCELLENCE	DATE
Executive Director, Sorting & Delivery Launch Team	DATE
SENIOR DIRECTOR, TECHNOLOGY DEVELOPMENT AND APPLICATION	DATE

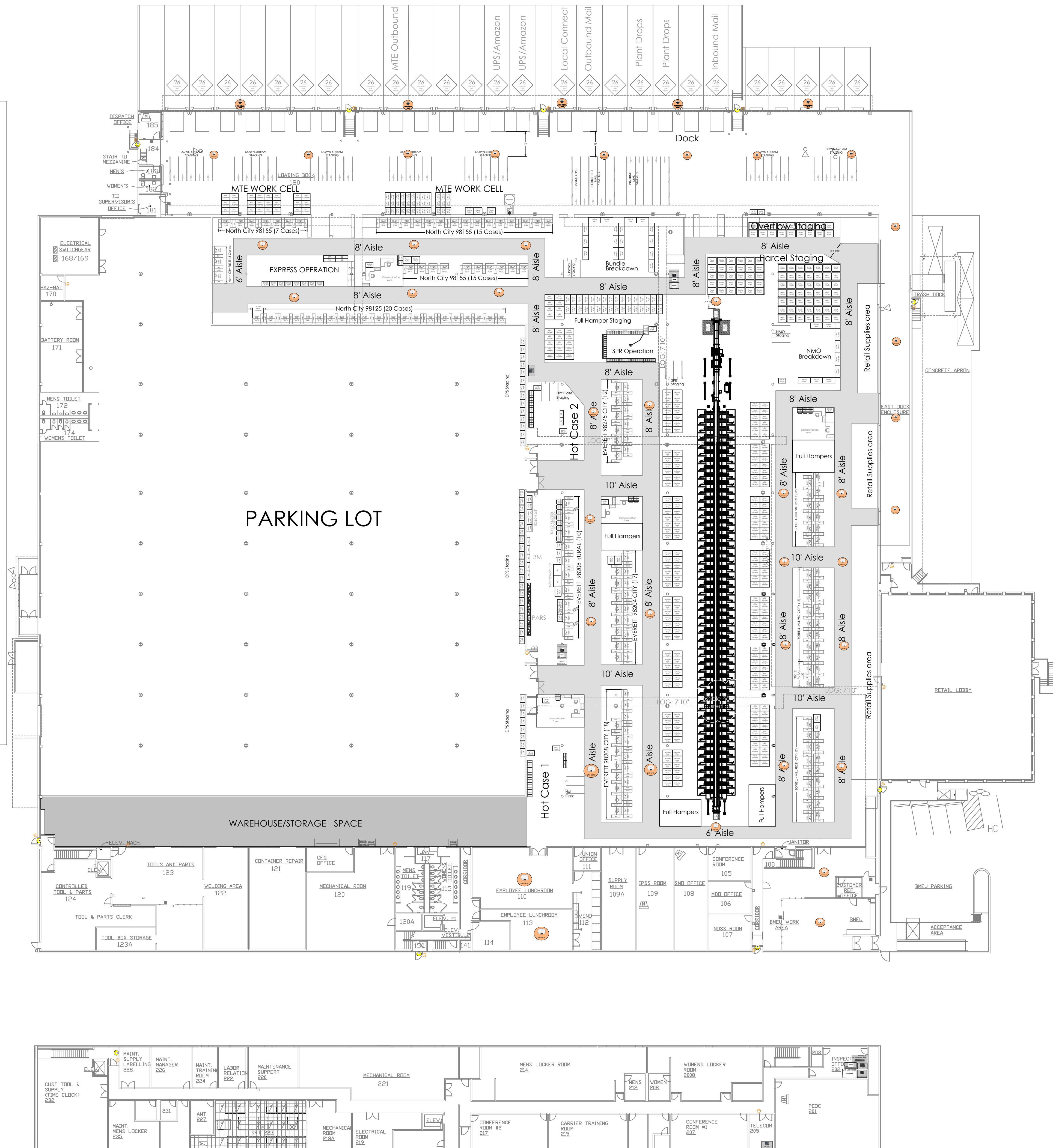

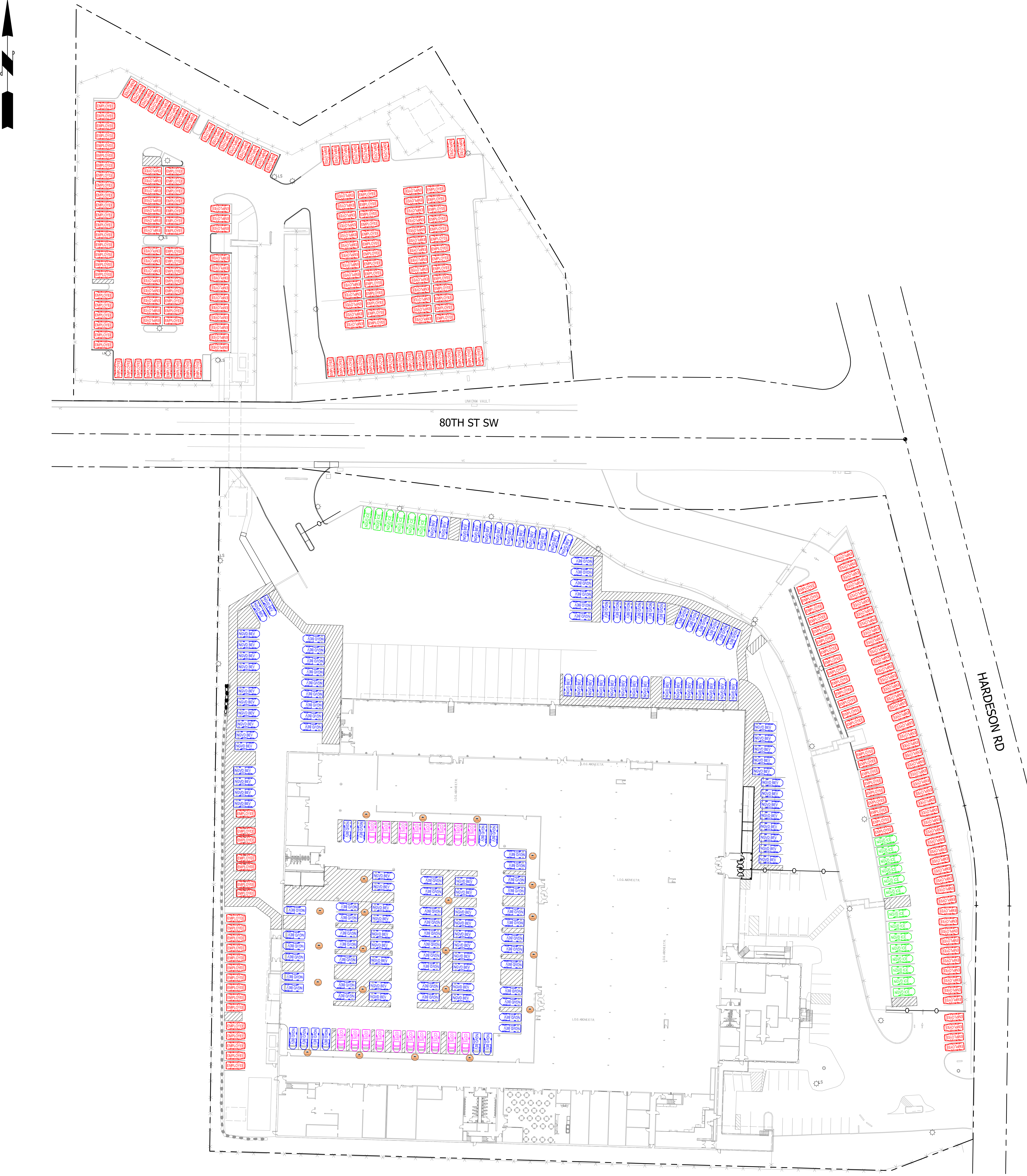
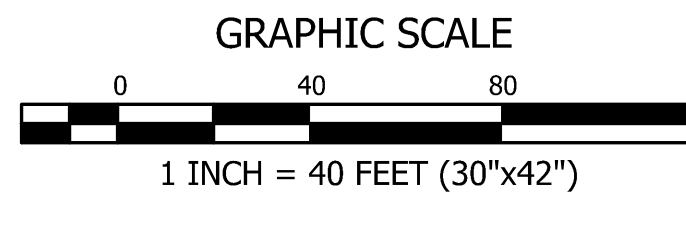

PARKING SPACES	CARRIER				EMPLOYEE	RETAIL
	LLV	NGDV BEV	NGDV ICE	COTS BEV		
EXISTING SPACES						35
TARGETED SPACES	146	0	16		203	35
TARGETED SPACES (+15%)	148	20	18		233	35
PROPOSED SPACES	148	20	18		269	35

VERIFICATION NOTE
 ALL EXISTING UTILITIES IN THE CONSTRUCTION AREA SHALL BE IDENTIFIED AND VERIFIED FOR DEPTH AND LOCATION PRIOR TO ANY CONSTRUCTION ACTIVITIES SO TO IDENTIFY ANY POTENTIAL CONFLICTS WITH PROPOSED CONSTRUCTION. CONTACT PROJECT ENGINEER IMMEDIATELY IF ANY CONFLICTS ARE IDENTIFIED.

PRIOR TO ANY CONSTRUCTION ACTIVITIES, VERIFY EXISTING TOPOGRAPHY IS CONSISTENT WITH WHAT IS SHOWN ON PLANS AND IF THERE ARE ANY POTENTIAL CONFLICTS WITH PROPOSED CONSTRUCTION ACTIVITIES, CONTACT PROJECT ENGINEER IMMEDIATELY IF ANY CONFLICTS ARE IDENTIFIED.

CALL 811 AT LEAST 48 HOURS BEFORE YOU DIG

EVERETT S&DC

Area: WestPac
District: Washington
Site: Everett Hub
ZIP Code: 98203

ROUTE INFO

Current City Routes47
Current Rural Routes10
Total Current Routes47

Future City Routes 150
Future Rural Routes 12
Total Future Routes 162

MACHINE INFO

Sort Plan 1 Sort Plan
Current SDUS 64 Bins
Proposed SDUS 200 Bins

SPOKE SUMMARY

Spokes

- Bothell-Mill Creek PO
- 98012 - 30 City, 2 Rural
- 98021 - 17 City, 0 Rural
- North City CAX
- 98125 - 30 City, 0 Rural
- 98155 - 26 City, 0 Rural

Total Fit Spoke Routes 105

OTHER NOTES

1. Addition of the SDUS+ had shifted the reject bin closer to the bottom aisle. Aisle was reduced from 8' down to 6' to allow for space
2. LOG closest to the end of the machine may need to be notched

APPROVAL - Description	DATE
EXECUTIVE DIRECTOR, INSIGHTS AND OPERATIONAL EXCELLENCE	DATE
Executive Director, Sorting & Delivery Launch Team	DATE
SENIOR DIRECTOR, TECHNOLOGY DEVELOPMENT AND APPLICATION	DATE

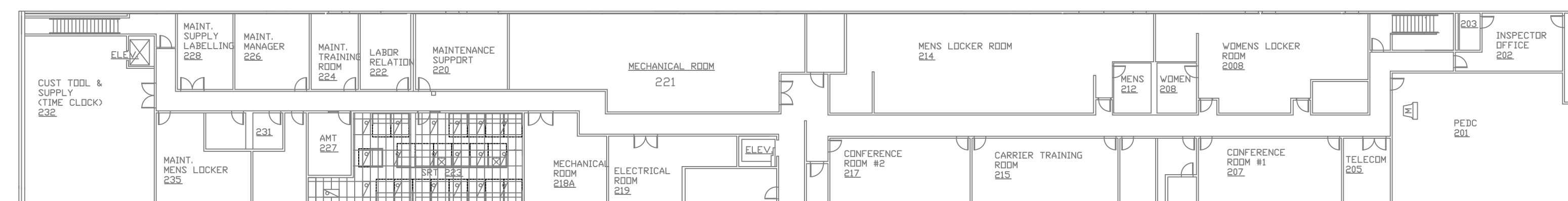
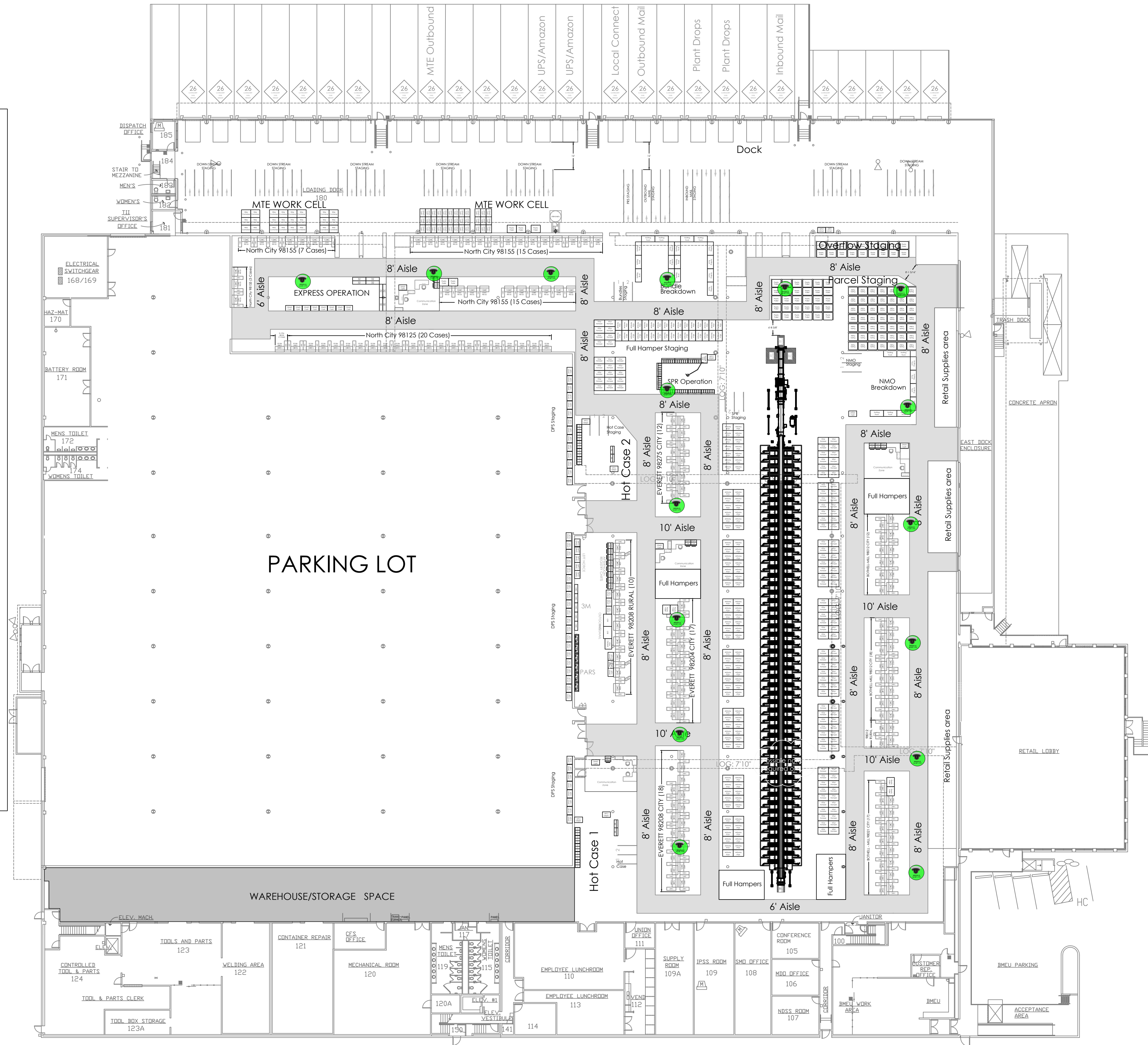

Operations Analytics Cameras										
Description	Quantity	Model	Cable Type	Cable Color	PoE Type	Mount	Mounting Height	Camera Network	Surge Protection Needed	Conduit
Axis M5000-G Three-Sensor + PTZ Camera	16	M5000-G	Cat6	Orange	PoE (15W)	1.5 NPT	10'-15' AFF	Analytics	No	Yes

Inspection Services Devices											
Description	Quantity	Model	Cable Type	Cable Color	PoE Type	Mount	Mounting Height	Camera Network	Surge Protection Needed	Reader Height	Conduit
Axis P3267-LVE	10	Axis P3267-LVE	Cat6	Purple	PoE (15W)	Above Door	12'-15' AFF	Security	Yes		Yes
C9200L-24P-4G-A	3	C9200L-24P-4G-A									
Great Lakes #GL7202436	1	Great Lakes DC07844A									
Great Lakes DC07844A	2	Great Lakes DC07844A									
Hanwha SPD-152	1	SPD-152	Cat6	Blue		Mounted in Security Server rack		Security			
March Networks X-Series IP Recorder	1	March Networks X-Series IP Recorder									
PNM-9031RV	5	PNM-9031RV	Cat6	Purple	PoE+ (30W)	SBP-276HMW & SBP-300WMW1 & SBV-253WCW	15'-18' AFF	Security	Yes		Yes
QNF-9010	2	QNF-9010	Cat6	Purple	PoE (15W)	Ceiling		Security	No		No
QNF-9010	25	QNF-9010	Cat6	Purple	PoE (15W)	1.5 NPT	12'-15' AFF	Security	No		Yes
QNF-9010RV	12	QNF-9010RV	Cat6	Purple	PoE (15W)	1.5 NPT	12'-15' AFF	Security	Yes		Yes
SMART1000RMXL2U	3	SMART1000RMXL2U									
XNF-9010RV	10	QNF-9010RV	Cat6	Purple	PoE (15W)	1.5 NPT	10'-15' AFF	Security	Yes		Yes
XNF-9010RV	12	QNF-9010RV	Cat6	Purple	PoE (15W)	SBP-160TMW1	10'-15' AFF	Security	Yes		Yes

Vanderbilt Access Control							
Description	Quantity	Model	Cable Type	Cable Color	Reader Height	Conduit	
Card Reader Connected To The Access Control System	19	RP40	Access Control Composite	Yellow	42" AFF	Yes	
VRCNX-A	2						